

# BALL SPLINE

## KEYLESS BLOCK TYPE

Material: Carbon Steel  
Add SS to P/N for Stainless Steel

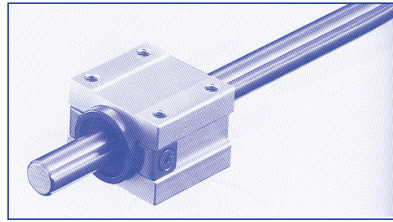

**New**

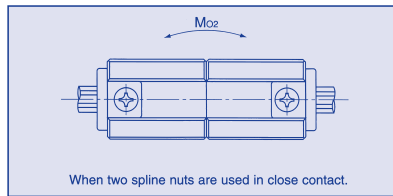

Part Number	Major Dimensions											
	h	E	W	L	F	L <sub>1</sub>	T	B	C	S	ℓ	D
	mm	mm	mm	mm	mm	mm	mm	mm	mm	mm	mm	mm
MYC-A3-1	9	12.5	25	25	18	22.5	4.2	18	16	M3	5	14
MYC-A3-2	10	14	28	25	20	22	5	20	16	M3	5	16
MYC-A3-3	12.5	16.5	33	33	25	30	7.5	25	20	M4	6	21

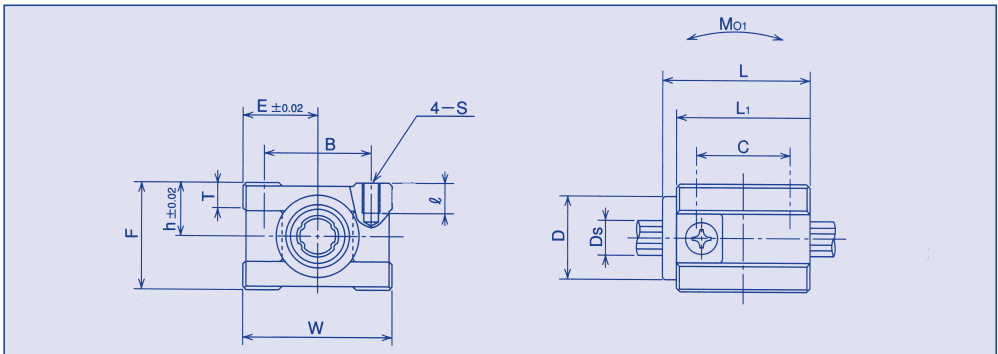

Must specify spline shaft length

D <sub>s</sub>		Basic Torque Rating		Basic Load Rating		Allowable Static Moment		second cross-sectional moment of Inertia mm <sup>4</sup>	cross-sectional coefficient mm <sup>3</sup>	Mass		Part Number
		dynamic C <sub>T</sub> N . m	static C <sub>0T</sub> N . m	dynamic C kN	static C <sub>0</sub> kN	M <sub>01</sub> N . m	M <sub>02</sub> N . m			Nut kg	Shaft kg/m	
mm	Tolerance μ m											
6	0/-12	1.5	2.4	1.22	2.28	5.1	40	59	19.7	0.035	0.21	MYC-A3-1
8	0	2.1	3.7	1.45	2.87	7.4	50	190	47.6	0.042	0.38	MYC-A3-2
10	-15	4.4	8.2	2.73	5.07	18	116	461	92.2	0.088	0.6	MYC-A3-3

1kN ≈ 102Kgf 1N ≈ 0.102Kg\*f/m

**NORDEX**

**(800) 243-0986 66M**  
In CT (203) 775-4877